





"Saheb Group" was established in 1997 and since inception has become a leading supplier of Home & Institutional furniture to the retail & corporate market of Jammu & Kashmir. From insertion of manufacturing activity of Home & Institutional furniture in 2003 "Saheb Group" has built a reputation of being furniture manufacturers & suppliers that are affordable, honest and easy to work with. As a result we have grown from strength to strength growing tenfold in 20 years.

Essentially, we're a one-stop shop for all of your home & office furniture and IT Solution's requirements. From urgent furniture and IT Solution needs through to specialized project requirements, you can be assured of the most professional, creative, personalized and prompt service in the industry. "Saheb Group" is a place of abundant drive, passion and inspiration, where clients are valued and deadlines are respected.

#### INFRASTRUCTURE

"Saheb Group" offers personalized and dedicated services to clients across the country with offices in Srinagar, Jammu and New Delhi. "Saheb Group" head office is located at Hyderpora the Posh Locality of Srinagar, and "Saheb Group" is having its plants at Srinagar itself, One is located in the heart of Srinagar City under the name of "SAHEB EXPORTS" with manufacturing capacity of more 300000 units of various products with strength highly skilled employees from last 7 years and other giant Unit under the name of "Saheb Industries" is located at Khunmoh District Srinagar on 1 Acre of Land, with Building infrastructure of more than 85000 SFT's and the production capacity of more 80000 Lakh Units of different products of Furniture & IT Industry, with strength highly skilled employees. On the other hand "Saheb Group" had a sprawling showroom of Twenty Thousand Square feet's located at Hyderpora Srinagar. Besides display showroom, "Saheb Group" has the central warehouse facilities of more than 200000 Sft's which is based in Delhi & Srinagar supporting our Plants, Showroom's & Offices.

#### LOGISTICS, WAREHOUSING AND CUSTOMER CARE

"Saheb Group" manages its own warehouse, fleet of delivery trucks and installation crews, thus directly responsible for all manufacturing, storage, delivery and installation of goods. After installations the "Saheb Group" installers, who are easily identifiable on site with their "Saheb Group" branded uniforms, level all desks, cabinets and IT Gadgets, wipe down all goods and undertake a quality check. Should anything be below standard, it is immediately escalated to "Saheb Group" Customer Care for replacement.

#### SERVICES

Whether it is Bed Room Chair or small, medium or large institution, perhaps just starting out, looking to expand or looking for a full turnkey solution, we're the Furniture & IT Company with the right expertise and dedicated resources to handle your furniture and IT requirements. A variety of services together with our comprehensive ranges of furniture and IT products we will be able to cater for all your needs.

#### INTERNAL SALES

The Internal Sales Department is able to speedily assist you telephonically with information and pricing on our full catalogue range of furniture and IT products or upon visiting our showroom.

#### SALES CONSULTANTS

Our area based sales consultants will gladly visit you in the comfort of your office. There they can get a feel for your environment, assess your needs, and give specialized advice. The Consultants will measure your office space and provide you with a space plan layout and a professional presentation.

Who we are

## DESIGN

Our in-house Design Department enables us to interactively work with each of our clients by using the latest CAD 2D and Revit 3D technology.

There aren't many furniture and IT companies together that can say the same, and this enables us to generate accurate and effective space planning, together with graphic renderings of creative designs and IT solutions to produce the ideal working environment that will enhance productivity and keep you connected and up-to-date with outer world technology.

## PROJECTS

The interior design and IT services and development or refurbishment of your facility is a process that entails a synthesis between the aesthetics as well as the functionality of the space. We are focused on creating innovative, inspiring office interiors using the latest software technology to create work environments that facilitate optimal performance.

The Project Department offers interior solutions from minor alterations through to a full turn-key interior design & fit out. Our services encompass all aspects of:

- Evaluation of existing workspace
- Latest IT Gadgets
- Conferencing Solutions
- Space planning
- Interior design & concept development
- Interior contracting & construction
- Selection & Supply of Furniture, IT Solutions, IT Products & Accessories

## CLIENTS

- His Excellency Governor's Office Jammu & Kashmir Government
- Honorable Chief Ministers Secretariat & Official Residences
- Honorable High Court Judges Residences
- Honorable Cabinet Ministers Offices & Residences
- J&K Accountability Commission
- J&K State Vigilance Organisation
- Indian Army
- Central Reserve Police Force
- District Magistrate Offices
- J&K Education Department
- J&K Tourism Department
- J&K Rural Development Department
- J&K R&B Department
- Commercial Taxes Complex J&K Government
- Airtel
- Aircel
- Chevrolet
- Maruti Suzuki
- Reliance
- Ircon

## CORPORATE SOCIAL RESPONSIBILITY

At Saheb Group we have always believed that good values and good business go hand in hand. It's part of our heritage and the way we do things today. CSR is about growing our business responsibly. At CSR we believe "To actively contribute to the social and economic development of the communities in which we operate. In so doing, build a better, sustainable way of life for the weaker sections of society and serious concern for the fragile environment of Jammu & Kashmir" Saheb Group has a tradition of caring for the environment and enriching the quality of lives of the communities we live and work in, through a variety of result-oriented programs:

- Commitment to the Zero Damage to Environment
- Growing Community Value
- Periodical Free Health Checkups in Under Developed Areas

**Saheb™ Group**  
**Saheb™ International | Saheb™ Exports | Saheb™ Industries**  
**Saheb™ Complex**

Hyderpora (Near Flyover) Srinagar-190014, J&K, India

Contact: 0194-2432159

Factory/Plant: Cement Factories Road, Khonmoh, Srinagar-191102, J&K, India



# Our Father (Deda) Our Inspiration



"Son's... no matter how many years go by,  
no matter how far you're away from me.  
Nothing can change the bond between us,  
my baby, you'll always be...  
And I am always with you"

Haji Shaykh Noor Muhammad  
(28th November 1950 to 10th June 2014)



## Be 'Smart'

**W**e are step forward in achieving our goal, but before I invite you all to turn the pages to see our product's in our first High Resolution Product Catalogue 2015, I take an opportunity to share perplexity of my mind which actually keeps me going. . The fuel for my creative thinking that yields innovation is not my similarities, but my differences. Good social interaction and creative thinking skills allow me productive and innovative ideas to build from differences of perspective and opinion. I believe innovation comes from differences; it takes maturity to play well with people who see the world differently, have different interests, and do not share your particular personality characteristics, preferences and style. It takes me a desire to find the value in difference, rather than a habit of only seeing the downside of a difference. With the inception of "Saheb™ Industries" we manufacture the products on the architecture of modern approach "SMART" from the Boss Chair or Naughty Children bed or your high-tech Audio Video conference rooms, high tech Security equipments, Surveillance equipments and media related equipments & much more you will surely experience SMART technology imbibed in the designs & development of our products.

We at "Saheb™ Industries" are determined to think on the principles of SMART technologies; our products are ergonomically designed without making compromise on the aesthetic feature, nevertheless ignoring the principles of the SMART technology.

Here wishing you all a pleasant experience in our High Resolution Product Catalogue 2017.

Hope to see some SMART product in your space soon. Enjoy the pages.....

**Shaukat Iqbal**  
CMD





## Observation -my comrade!

**W**e at "Saheb Group" would like to welcome attention on our company's product catalogue. We have been providing best furniture & IT solutions in this town for 20 years manufactured in our plants. People have witnessed how our group has grown into an extremely progressive area and it has gained its reputation for being the favourite furniture company.

"Saheb Group" provides all kinds of furniture be it Home Furniture or Institutional Furniture. We are also integration Partners of SHURE/DIS CONFERENCING SOLUTIONS. We are highly expert company in the area of Commissioning, Providing, Integration, Installation & maintenance of Conferencing Solutions. We employ only the most knowledgeable and highly skilled individuals in our industry.

Being the head of operations at "Saheb Group", I would also like to take this opportunity to give you an invitation to the visit our new Showroom at Hyderpora where you can see the full display of our products. Also I also invite you to spend some time in a dedicated Study area well established for our customers in the complex itself. You can find best books & IT Information about Furniture & Conferencing.

Once again, welcome, and we're glad you came to our "neighborhood".

**Shaykh Mukhtar**  
CEO/Director Finance  
Saheb Group





## Modular Office Furniture Catalogue



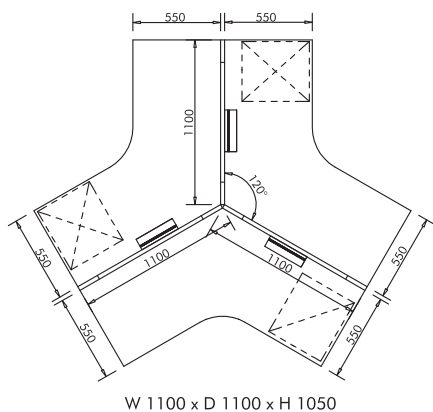

## Technical Specification

- Desk based System with 25 mm Screen.
- Powder coated triangle frame leg.
- Raceway provision below the work top for data & electrical wiring.



**OPTIMA-I**



**OPTIMA-2**

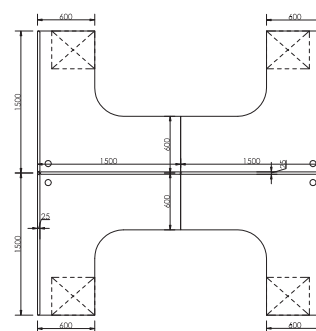

W 3000 x D 3000 x H 1050

**Technical Specification**

- Desk based System with 25 mm Screen.
- Powder coated triangle frame leg.
- Raceway provision below the work top for data & electrical wiring.



**OPTIMA-3**

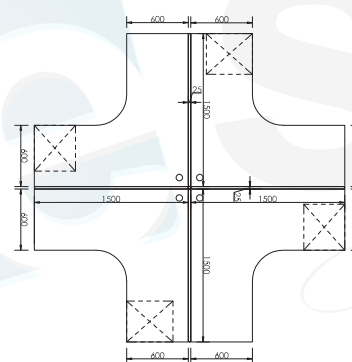

W 3025 x D 3025 x H 1050

**Technical Specification**

- Desk based System with 25 mm Screen.
- Powder coated triangle frame leg.
- Raceway provision below the work top for data & electrical wiring.



**OPTIMA-4**

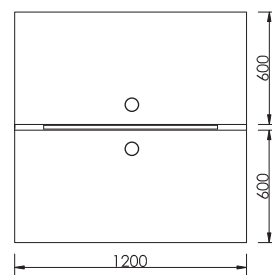

W 1200 x D 1225 x H 1050

**Technical Specification**

- Desk based System with 25 mm Screen.
- Powder coated triangle frame leg.
- Raceway provision below the work top for data & electrical wiring.

## STRATUM-1

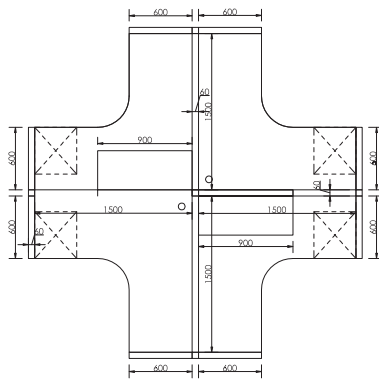

W 3180 x D 3180 x H 1650

### Technical Specification

- 60mm panel based partition systems.
- Flat top and end covers.
- End covers with plastic sliding strips.
- Aluminum extruded sections.
- 100mm height of raceway for data & electrical wiring.



## STRATUM-2

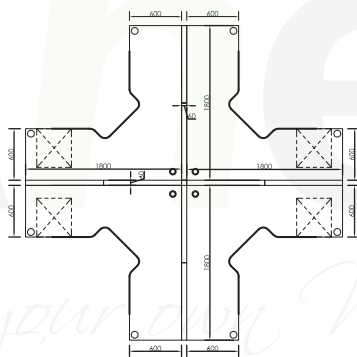

W 3660 x D 3660 x H 1200

### Technical Specification

- 60mm panel based partition systems.
- Flat top and end covers.
- End covers with plastic sliding strips.
- Aluminum extruded sections.
- 100mm height of raceway for data & electrical wiring.



## STRATUM-3

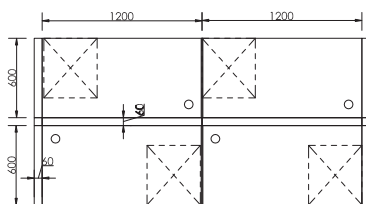

W 2520 x D 1260 x H 1200

### Technical Specification

- 60mm panel based partition systems.
- Flat top and end covers.
- End covers with plastic sliding strips.
- Aluminum extruded sections.
- 100mm height of raceway for data & electrical wiring.







**DUAL-I**  
L 2400 x D 1260 x H 1200

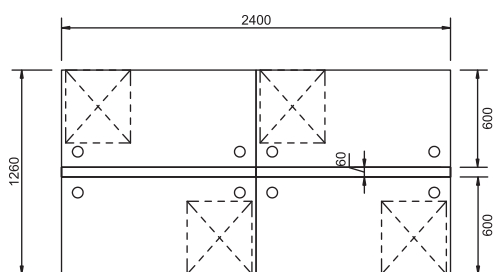

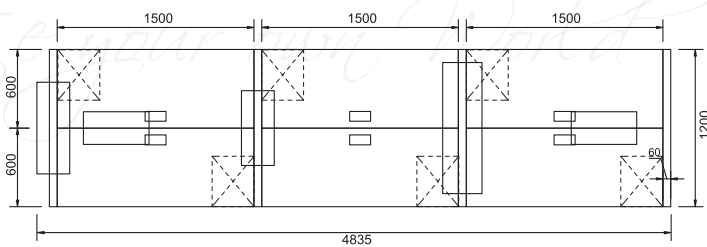

**ZESTA-I**  
L 4835 x D 1200 x H 1600





**ZESTA-2**

L 1715 x D 1200 x H 1600

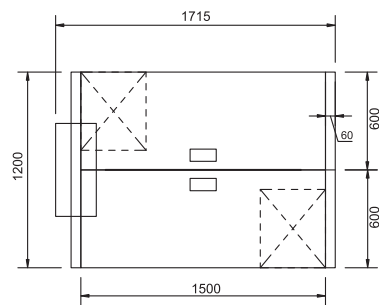



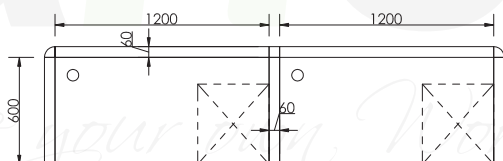

**MAX-2**  
W 2580 x D 660 x H 1200

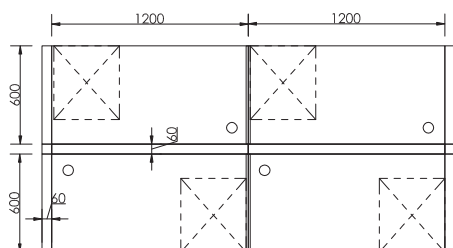

**MAX-4**  
W 2520 x D 1260 x H 1200



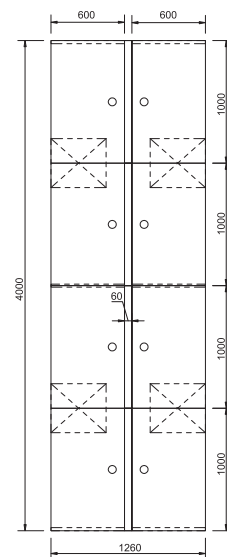

**MAX-5**  
L 4000 x D 1260 x H 1200

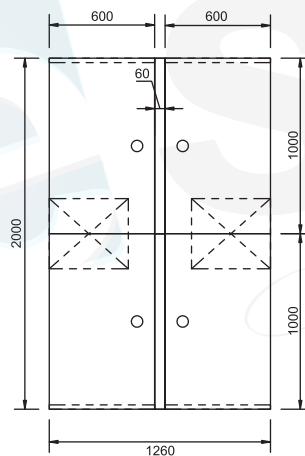

**MAX-6**  
L 2000 x D 1260 x H 1200

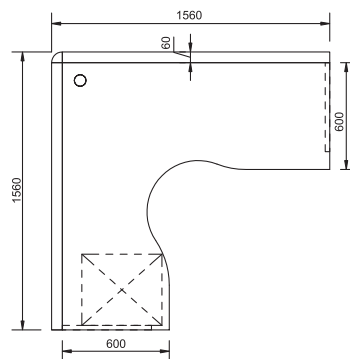

**MAX-7**  
L 1560 x D 1560 x H 1200



L 2200 X D 1950 X H 750  
L 2000 X D 1850 X H 750  
L 1800 X D 1750 X H 750

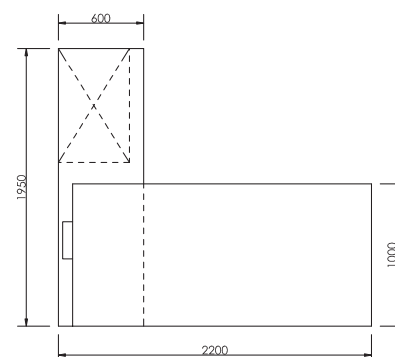

**EXCLUSIVE-2**  
L 2200 x D 1950 x H 750

L 2400 X D 2175 X H 750  
L 2200 X D 2175 X H 750  
L 2000 X D 2075 X H 750

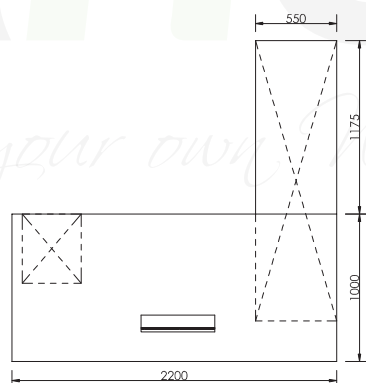

**EXCLUSIVE-3**  
L 2200 x D 2175 x H 750



L 2800 X D 2200 X H 750  
L 2600 X D 2100 X H 750

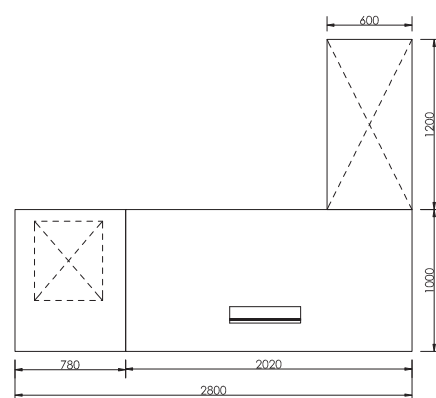

**EXCLUSIVE-4**  
L 2800 x D 2200 x H 750



L 2250 X D 2180 X H 750  
L 2000 X D 2100 X H 750  
L 1800 X D 2000 X H 750

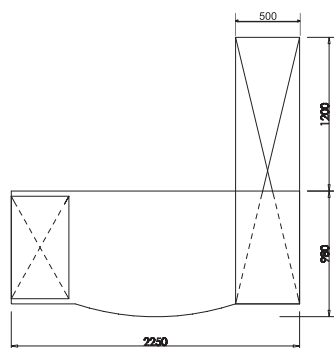

**EXCLUSIVE-5**  
L 2250 x D 2180 x H 750



L 1800 X D 1730 X H 750  
L 1650 X D 1650 X H 750

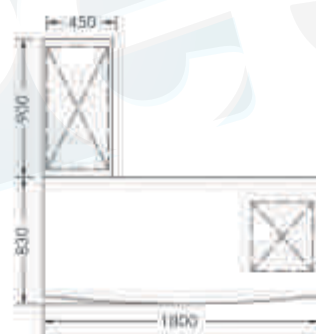

**EXCLUSIVE-6**  
L 1800 x D 1730 x H 750

L 2100 X D 1800 X H 750  
L 1950 X D 1700 X H 750  
L 1800 X D 1650 X H 750

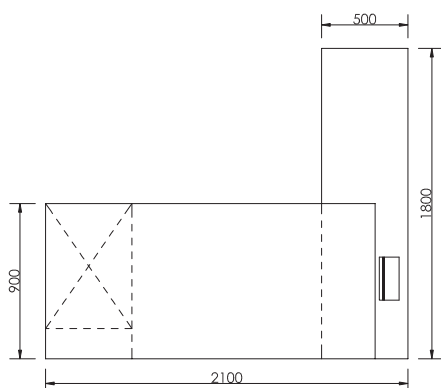

**EXCLUSIVE-7**  
L 2100 x D 1800 x H 750



L 2400 X D 2300 X H 750  
L 2100 X D 2200 X H 750

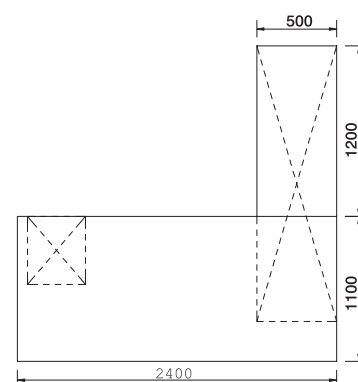

**EXCLUSIVE-8**  
L 2400 x D 2300 x H 750

L 2450 X D 2200 X H 750  
L 2250 X D 2100 X H 750

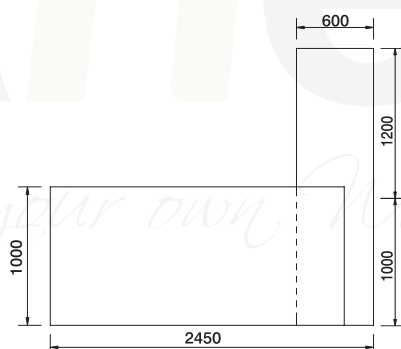

**EXCLUSIVE-9**  
L 2450 x D 2200 x H 750



L 2300 x D 1950 X H 750  
L 2100 x D 1850 x H 750

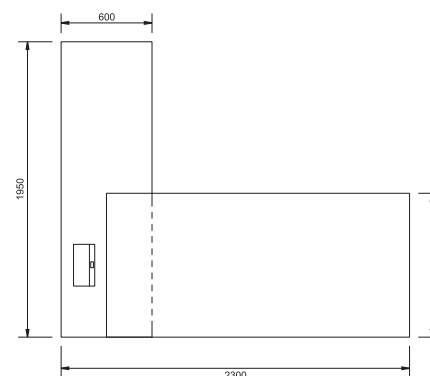

**EXCLUSIVE-10**  
L 2300 x D 1950 x H 750

L 2000 x D 1850 x H 750  
L 1800 x D 1750 x H 750

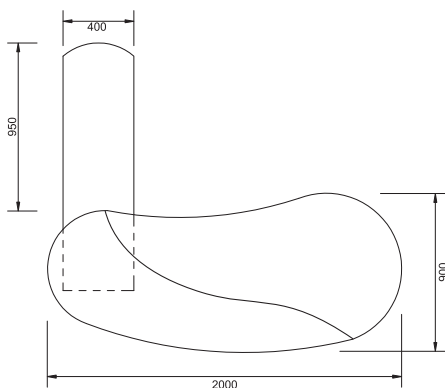

**EXCLUSIVE-11**  
L 2000 x D 1850 x H 750



L 1800 x D 2000 x H 750  
L 1600 x D 1900 x H 750

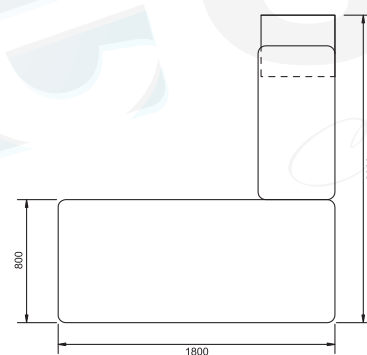

**EXCLUSIVE-12**  
L 1800 x D 2000 x H 750

L 2400 x D 1000 x H 750  
L 2000 x D 900 x H 750

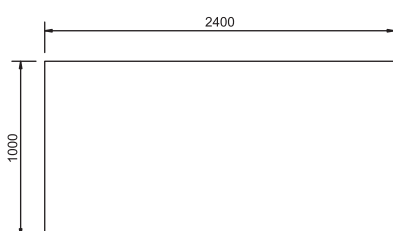

**EXCLUSIVE-13**  
L 2400 x D 1000 x H 750



**CLASSIC-2**  
L 2300 x D 1800 x H 750

L 2300 X D 1800 X H 750  
L 2100 X D 1800 X H 750  
L 1800 X D 1800 X H 750

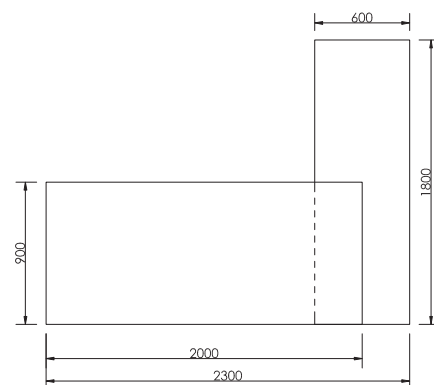

L 1800 X D 1800 X H 750  
L 1600 X D 1700 X H 750

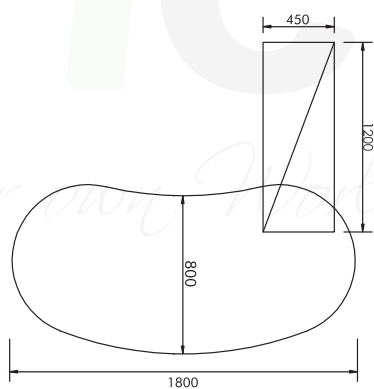

**CLASSIC-3**  
L 1800 x D 1800 x H 750



**CLASSIC-4**  
L 2200 x D 2000 x H 750

L 2200 X D 2000 X H 750  
L 2000 X D 1900 X H 750

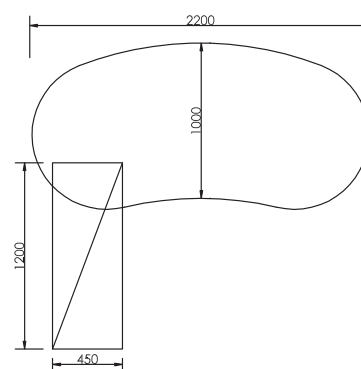



L 1800 X D 1700 X H 750  
L 1600 X D 1600 X H 750

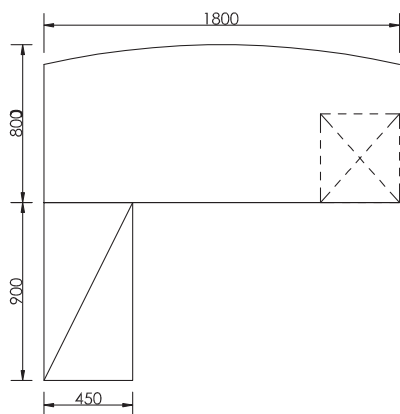

**CLASSIC-5**  
L 1800 x D 1700 x H 750



L 1600 X D 1700 X H 750  
L 1800 X D 1800 X H 750  
L 2000 X D 1900 X H 750

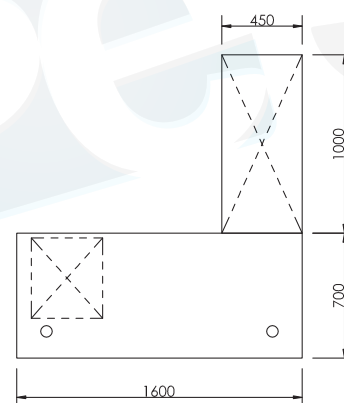

**CLASSIC-6**  
L 1600 x D 1700 x H 750

L 1950 X D 2000 X H 750  
L 1800 X D 2000 X H 750  
L 1650 X D 1900 X H 750

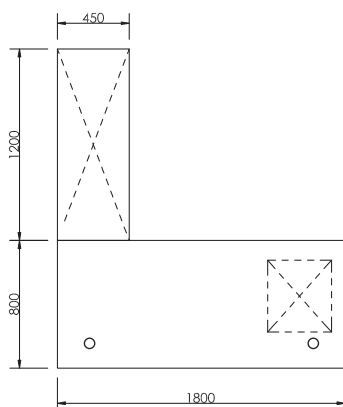

**CLASSIC-8**  
L 1800 x D 2000 x H 750

## Classicseries



L 1950 X D 1800 X H 750  
L 1800 X D 1700 X H 750  
L 1600 X D 1600 X H 750

**CLASSIC-9**  
L 2050 x D 1600 x H 750

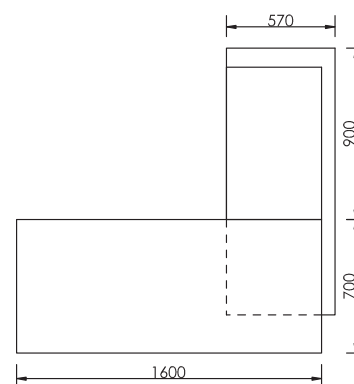

## NumeroSeries

L 1950 X D 2000 X H 750  
L 1800 X D 2000 X H 750  
L 1650 X D 1900 X H 750

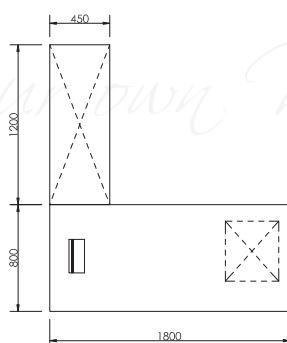

**NUMERO-I**  
L 1800 x D 2000 x H 750



**NUMERO-2**  
L 1400 x D 700 x H 750

L 1600 X D 700 X H 750  
L 1500 X D 700 X H 750  
L 1400 X D 700 X H 750

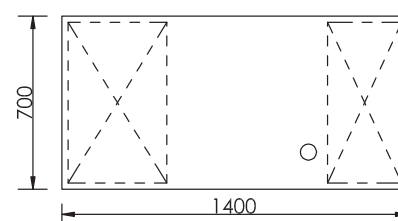

L 1350 X D 600 X H 750  
L 1200 X D 600 X H 750

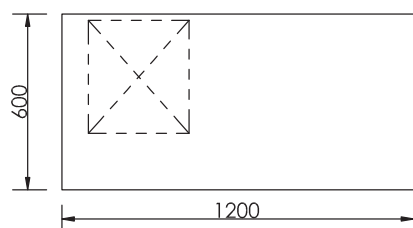

**NUMERO-3**  
L 1200 x D 600 x H 750



**NUMERO-4**  
L 2400 x D 2400 x H 750

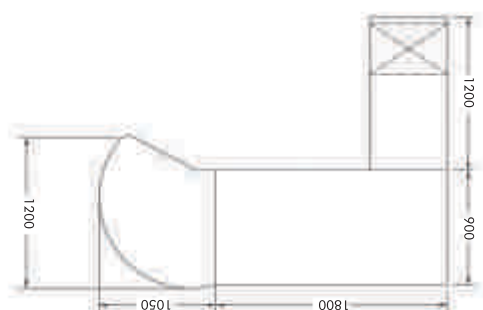
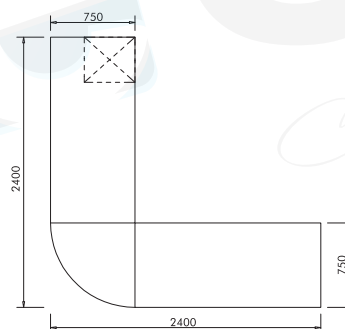

**NUMERO-5**  
L 2850 x D 2100 x H 750 L 1500 x D 750 x H 750



**NUMERO-6**  
L 1650 x D 1650 x H 750

L 1950 X D 1750 X H 750  
L 1800 X D 1650 X H 750  
L 1650 X D 1650 X H 750

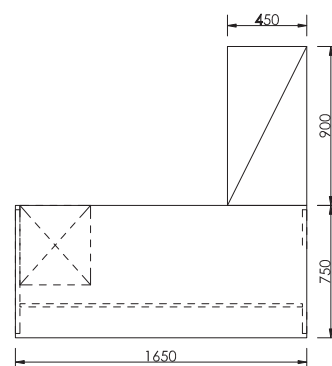

L 1500 X D 750 X H 750  
L 1350 X D 600 X H 750  
L 1200 X D 600 X H 750

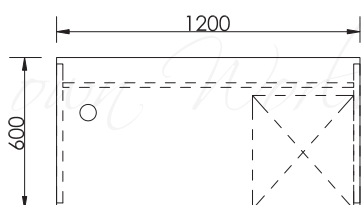

**NUMERO-7**  
L 1200 x D 600 x H 750



**NUMERO-8**  
L 1500 x D 1650 x H 750

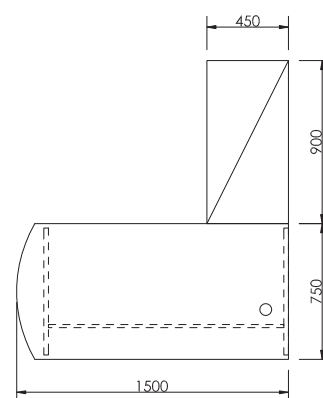



L 3600 X D 1200 X H 750  
L 3000 X D 1200 X H 750  
L 2400 X D 1200 X H 750

L 3600 X D 1200 X H 750  
L 3000 X D 1200 X H 750  
L 2400 X D 1200 X H 750



**CONFERENCE-I**  
L 2400 x D 1200 x H 750



**CONFERENCE-2**  
L 2400 x D 1200 x H 750



**CONFERENCE-4**  
L 6000 x D 3000 x H 750



L 5400 X D 1500 X H 750  
L 4500 X D 1500 X H 750  
L 3600 X D 1200 X H 750

**CONFERENCE-5**  
L 3600 x D 1200 x H 750

L 2700 X D 900 X H 750  
L 2100 X D 900 X H 750  
L 1800 X D 800 X H 750

L 2100 X D 1200 X H 750  
L 1800 X D 900 X H 750



**CONFERENCE-6**  
L 1800 x D 800 x H 750



**CONFERENCE-7**  
L 2100 x D 1200 x H 750

## Conference<sub>series</sub>



L 1800 X D 900 X H 750  
L 1500 X D 750 X H 750

Ø 1200 X 750 mm  
Ø 900 X 750 mm



**CONFERENCE-8**  
L 1500 x D 750 x H 750



**CONFERENCE-9**  
Ø 1200 x 750 mm

L 3600 X D 1200 X H 750  
L 3000 X D 1200 X H 750  
L 2400 X D 1200 X H 750



**CONFERENCE-10**  
L 3600 x D 1200 x H 750

## Reception<sub>series</sub>



**RECEPTION-1**  
L 2400 x D 820 x H 1000



**RECEPTION-2**  
L 2400 x D 700 x H 1000



**RECEPTION-3**  
L 1500 x D 600 x H 1000

# Computer Table



**COMPUTER DESK-I**  
L 1500 x D 750 x H 750



**COMPUTER DESK-2**  
L 1200 x D 600 x H 750

## Pedestalseries



**PEDESTAL-2**  
W 400 x D 560 x H 540



**PEDESTAL-2**  
W 440 x D 580 x H 600



**PEDESTAL-3**  
W 400 x D 450 x H 680



**PEDESTAL-I**  
W 400 x D 450 x H 680



**PEDESTAL-5**  
W 400 x D 600 x H 605



**PEDESTAL-6**  
W 400 x D 450 x H 680







**STORAGE-I**  
W 1800 x D 400 x H 2000



**STORAGE-2**  
W 1200 x D 400 x H 1850



**STORAGE-3**  
W 1600 x D 550 x H 2000



**STORAGE-4**  
W 900 x D 450 x H 2000



**STORAGE-5**  
W 900 x D 450 x H 750



**STORAGE-6**  
W 900 x D 450 x H 750



**STORAGE-7**  
W 900 x D 400 x H 900



**STORAGE-8**  
W 1800 x D 450 x H 750



**STORAGE-9**  
W 1500 x D 450 x H 750



**STORAGE-12**  
W 1800 x D 450 x H 900



**STORAGE-11**  
W 900 x D 450 x H 1200



**STORAGE-10**  
W 900 x D 450 x H 2100



**HIGH SWING DOOR**  
W=600,750,900  
D=450,500,550,600  
H=1800,2100



**HIGH SWING DOOR WITH GLASS & WOODEN SHUTTERS**  
W=600,750,900  
D=400,450,500,550,600  
H=1650,1800,2100



**MEDIUM SWING DOOR (2S)**  
W=600,750,900  
D=400,450,500,550,600  
H=1175,1200,1350,1500



**MEDIUM SWING DOOR (1S)**  
W=450,500,600  
D=400,450,500,550,600  
H=1175,1200,1350,1500



**OVER HEAD STORAGE**  
W=600,750,900,1050,1200  
D=300,350,380,400,450  
H=450,600,750,800,900



**LOW SWING DOOR**  
W=600,750,900,1050,1200  
D=400,450,500,550,600  
H=750,800,900



**LOW SLIDING DOOR**  
W=600,750,900,1050,1200  
D=400,450,500,550,600  
H=750,900,1200



**SIDE CABINET**  
W=600,750,900  
D=400,450  
H=750,900





10002 Mangfall Beech    10175 Asian Maple    11005 Neo Highland Pine    10091 Nova Teak    22091 Arctic White    21059 Platinum

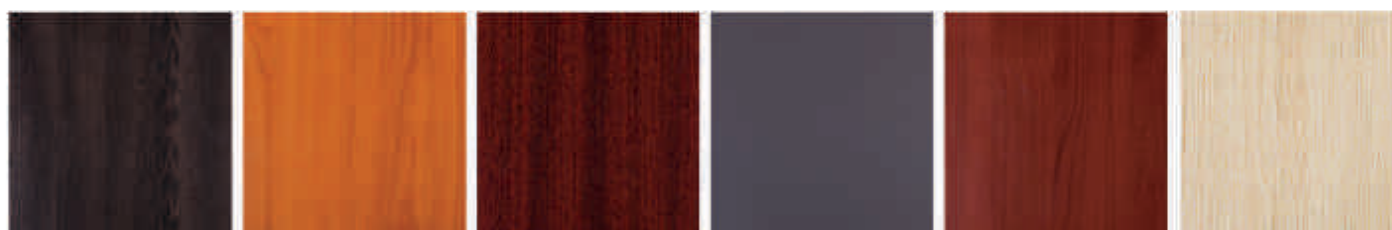

10858 Wenge    10012 Oxford Cherry    10699 Mahogany    22099 Slate    10145 Red Oxford Cherry    10007 Douglas Pine



10036 White Beech    11192 Neo Bavarian Beech    10544 Canadian Walnut    10031 Fine Oak    10848 Straight Walnut    10019 Sapelle

## Powder Coats



Black    Ivory    White    Chocolate Brown    Moon Grey    Silver Grey    Bone Grey    D.A. Grey

## Fabrics



Med Blue (F191)    Acorn (F 128)    Caramel (F 132)    China Sea (MS 407)    Roman Green (MS 440)    Lavender (MS 416)    Dago Orange (F 181)    Spearmint (F 102)



Flame (F 123)    Attenzione (MS 419)    Fresco (MS 420)    Cinnamon (MS 422)    Cream Blue    Cement Yellow (NE 817)    Beige Pacific Blue (NE 803)    Salmom (MS 425)

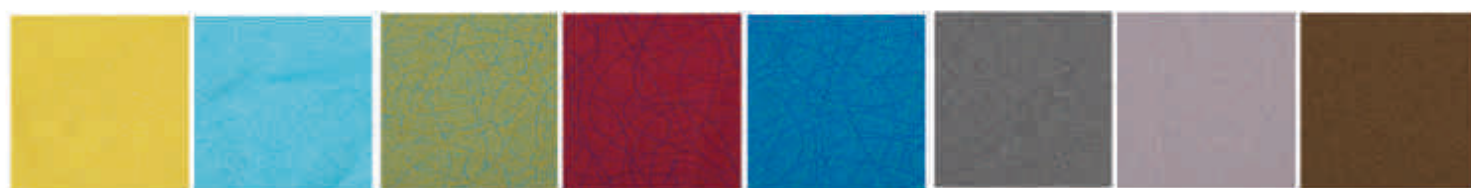

Reflection (MS 438)    Vesuvius (MS 410)    Gold Blue (NE 821)    Wine Blue (NE 822)    Blue (NE 824)    Granada (MS 452)    Mink (MS 449)    Dark Forest (MS 437)

■ (NE 801) Colours shown above for laminates, fabrics and powder coats will vary from the actual.

## Accessories



FLIP-1



FLIP-2



FLIP BOX



LAMINATED KEYBOARD TRAY



METAL CPU TROLLEY



WIRE MANAGER



ROUND POLE LEG



I LEG



VERTEBRAE-I



REDUCING LEG

## Powder Coating





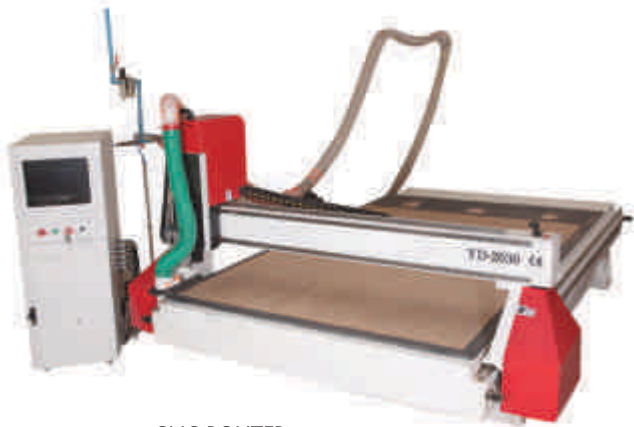

CNC ROUTER



PANEL SAW

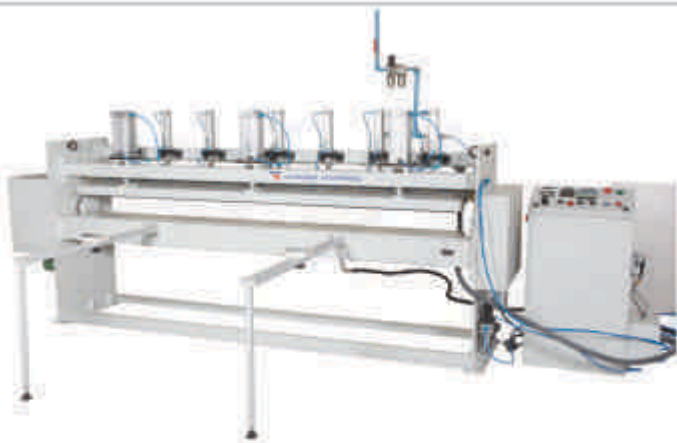

POSTFORMING MACHINE



3 HEAD MULTI BORING



THROUGH FEED EDGE BENDING



HOT PRESS



MANUAL EDGE BENDING



MANUAL TRIMMING MACHINE



SPINDLE MOULDER



# Experts in making of Hi-Tech Conference Halls





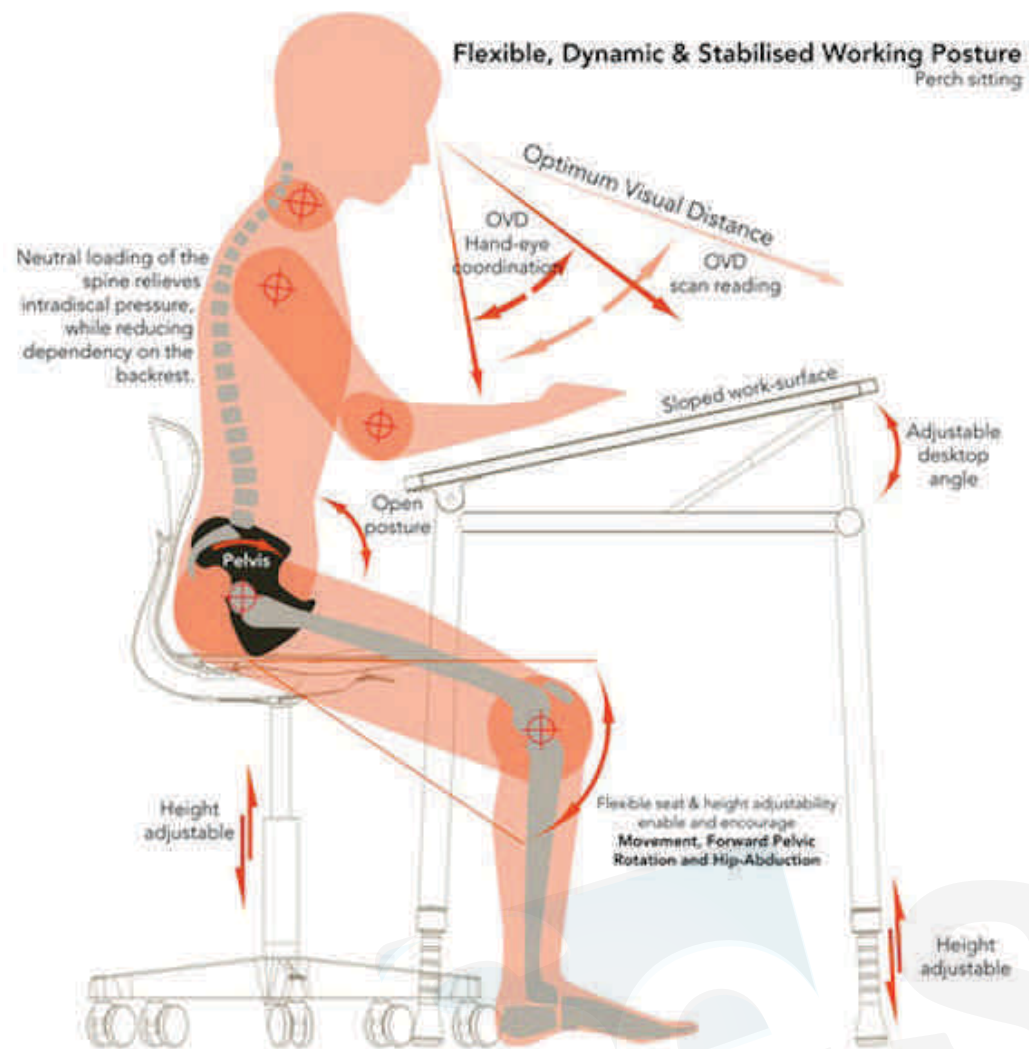

## GERMAN CERT Quality Management System Certificate

### SAHEB

located at  
CORPORATE OFFICE-4, GREEN ENCLAVE RAJBAGH EXTENSION SRINAGAR 190 008, KASHMIR

German Cert Co., Ltd. hereby certifies that the quality management system of the above organization has been evaluated and found to be in line with the requirements of the following standard:

**ISO 9001:2008**  
(Excluding Clause: 7.3 Design and Development)

for the scope of

**Manufacture and Supply of Furniture, Joinery and Furnishing Items and Hotel Services**

**Certificate Number: KorQ-131793**

This certificate is valid from June 18, 2013 until June 17, 2016.

Initial certification date: June 18, 2013  
GC certification date: June 18, 2013  
Certification valid until: June 17, 2016

*G. Cao*

Scheme Manager



GERMAN CERT  
QUALITY MANAGEMENT SYSTEM

100, Ikegawa Bldg., Yotsukado-dong, East-tang-ro 29, Yongsong-gu, Seoul 150-719, Korea  
This certificate is a sole property of GERMAN CERT and therefore shall be returned to it upon its request. (RSC4)



## GERMAN CERT

### Quality Management System Certificate

SAHEB

located at

CORPORATE OFFICE: 4, GREEN ENCLAVE RAJBAGH EXTENSION SRINAGAR 190 008, KASHMIR

German Cert Co., Ltd. hereby certifies that the quality management system of the above organization has been evaluated and found to be in line with the requirements of the following standard:

ISO: 9001:2000:14001

for the scope of:

Manufacture and Supply of Furniture, Joinery and Furnishing Items and Hotel Services

Certificate Number: KorQ-131793

This certificate is valid from June 18, 2013 until June 17, 2016.

Initial certification date: June 18, 2013  
GC certification date: June 18, 2013  
Certification valid until: June 17, 2016

*Y. Cao*

Scheme Manager



HQ: Jingsong Rdg, Youshi-dong, Taishang-ru 75, Youshi-dong-gu, Seoul 150-739, Korea  
This certificate is a sole property of GERMAN CERT and therefore shall be returned to it upon its request. (Rev.0)



## GERMAN CERT

### Quality Management System Certificate

SAHEB

located at

CORPORATE OFFICE: 4, GREEN ENCLAVE RAJBAGH EXTENSION SRINAGAR 190 008, KASHMIR

German Cert Co., Ltd. hereby certifies that the quality management system of the above organization has been evaluated and found to be in line with the requirements of the following standard:

ISO: 9001:2000:14001

for the scope of:

Manufacture and Supply of Furniture, Joinery and Furnishing Items and Hotel Services

Certificate Number: KorQ-131793

This certificate is valid from June 18, 2013 until June 17, 2016.

Initial certification date: June 18, 2013  
GC certification date: June 18, 2013  
Certification valid until: June 17, 2016

*Y. Cao*

Scheme Manager



HQ: Jingsong Rdg, Youshi-dong, Taishang-ru 75, Youshi-dong-gu, Seoul 150-739, Korea  
This certificate is a sole property of GERMAN CERT and therefore shall be returned to it upon its request. (Rev.0)



## GERMAN CERT

### Environmental Management System Certificate

SAHEB

located at

CORPORATE OFFICE: 4, GREEN ENCLAVE RAJBAGH EXTENSION SRINAGAR 190 008 KASHMIR, INDIA

German Cert Co., Ltd. hereby certifies that the environmental management system of the above organization has been evaluated and found to be in line with the requirements of the following standard:

ISO 14001:2004

for the scope of:

Manufacture and Supply of Furniture, Joinery, Furnishing Items, IT Products and Hotel Services

Certificate Number: KorE-145032

This certificate is valid from April 01, 2014 until March 31, 2015.

Initial certification date: April 01, 2014  
GC certification date: April 01, 2014  
Certification valid until: March 31, 2015

*Y. Cao*

Scheme Manager



HQ: Jingsong Rdg, Youshi-dong, Taishang-ru 75, Youshi-dong-gu, Seoul 150-739, Korea  
This certificate is a sole property of GERMAN CERT and therefore shall be returned to it upon its request. (Rev.0)



## GERMAN CERT

### OH&S Management System Certificate

SAHEB

located at

CORPORATE OFFICE: 4, GREEN ENCLAVE RAJBAGH EXTENSION SRINAGAR 190 008 KASHMIR, INDIA

German Cert Co., Ltd. hereby certifies that the occupational health and safety management system of the above organization has been evaluated and found to be in line with the requirements of the following standard:

OHSAS 18001:2007

for the scope of:

Manufacture and Supply of Furniture, Joinery, Furnishing Items, IT Products and Hotel Services

Certificate Number: KorO-140024

This certificate is valid from April 01, 2014 until March 31, 2015.

Initial certification date: April 01, 2014  
GC certification date: April 01, 2014  
Certification valid until: March 31, 2015

*Y. Cao*

Scheme Manager



HQ: Jingsong Rdg, Youshi-dong, Taishang-ru 75, Youshi-dong-gu, Seoul 150-739, Korea  
This certificate is a sole property of GERMAN CERT and therefore shall be returned to it upon its request. (Rev.0)



**Saheb™ Group**  
**Saheb™ International | Saheb™ Exports | Saheb™ Industries**  
**Saheb™ Complex**

Hyderpora (Near Flyover) Srinagar-190014, J&K, India

Contact: 0194-2432159

Factory/Plant: Cement Factories Road, Khonmoh, Srinagar-191102, J&K, India